

T—D

PCT Drilled from Solid Thermowell



Temperature Solutions from Premier Control Technologies

- Drilled from solid Thermowell
- Tapered Profiles
- No need for down time when sensor is replaced
- Manufactured to your specifications
- Other materials and connections available

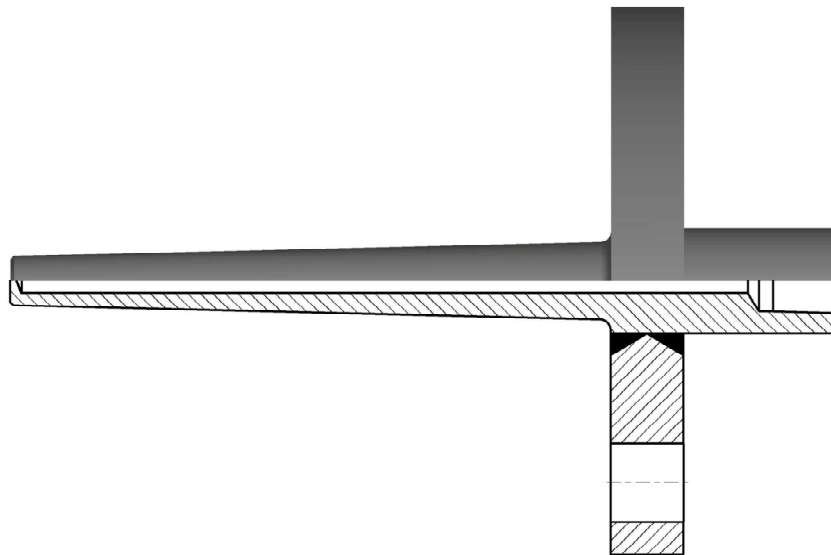

Specifications	
Material of Construction	316 Stainless Steel
Operating Temperature Range	-75 to +800 °c
Thread Types	1/4" BSP (Parallel and Tapered) 1/2" BSP (Parallel and Tapered) 3/4" BSP (Parallel and Tapered) 1" BSP (Parallel and Tapered) 1/2" NPT 3/4" NPT ANSI Flanges, all sizes available DN PN Flanges, all sizes available Other threads available upon request.

Premier Control Technologies Ltd

Unit 1 Oaktree Business Park, Philip Ford Way, Wymondham, Norfolk, NR18 9AQ

Tel: 01953 609930

Fax: 01953 713883

Email: sales@pctflow.com

Web: www.pctflow.com